

STAIR SCHEDULE			
MARK	LOCATION	STAIR DATA	COMMENTS
STAIR 1	FIRST FLOOR TO BASEMENT	12 RISERS @ 7 11/16" = 7'-8" 11 TREADS @ 10" = 9'-2"	VERIFY HEIGHT TO BASEMENT
STAIR 2	DINING ROOM TO KITCHEN	2 RISERS @ 7" = 1'-2" 1 TREADS @ 10" = 0'-0"	VERIFY HEIGHT BETWEEN DINING ROOM & KITCHEN
STAIR 3	BREEZEWAY TO GARAGE	10 RISERS @ 7 1/2" = 6'-3" 9 TREADS @ 12" = 9'-0"	VERIFY HEIGHT BETWEEN BREEZEWAY & GARAGE
STAIR 4	DINING ROOM TO KITCHEN	2 RISERS @ 7" = 1'-2" 1 TREADS @ 10" = 0'-0"	VERIFY HEIGHT BETWEEN DINING ROOM & KITCHEN
STAIR 5	GUEST SUITE	2 RISERS @ 7" = 1'-2" 1 TREADS @ 10" = 0'-0"	VERIFY HEIGHT BETWEEN FLOOR ELEVATION CHANGE

GENERAL ARCHITECTURAL NOTES:

- FOR ALL OTHER INFORMATION NOT SPECIFIED HERE WITHIN, REFER TO THE PROJECT SPECIFICATIONS.
- ALL EXISTING FRAMING BEING SUSPECT TO WATER, TERMITE, OR ANY OTHER FORM OF DAMAGE IS TO BE REPLACED WITH LIKE MATERIALS.
- ANY LOAD BEARING MEMBER THAT IS I.E., BEAM, GIRDER, POST THAT IS DAMAGED IN ANY FORM SHALL BE REPORTED TO THE ARCHITECT FOR PROPER STRUCTURAL REVIEW.
- G.C. TO COORDINATE FLOOR FINISH WITH OWNER.

1 FINISHED BASEMENT PLAN
A.1.2 SCALE: 1/4" = 1'-0"

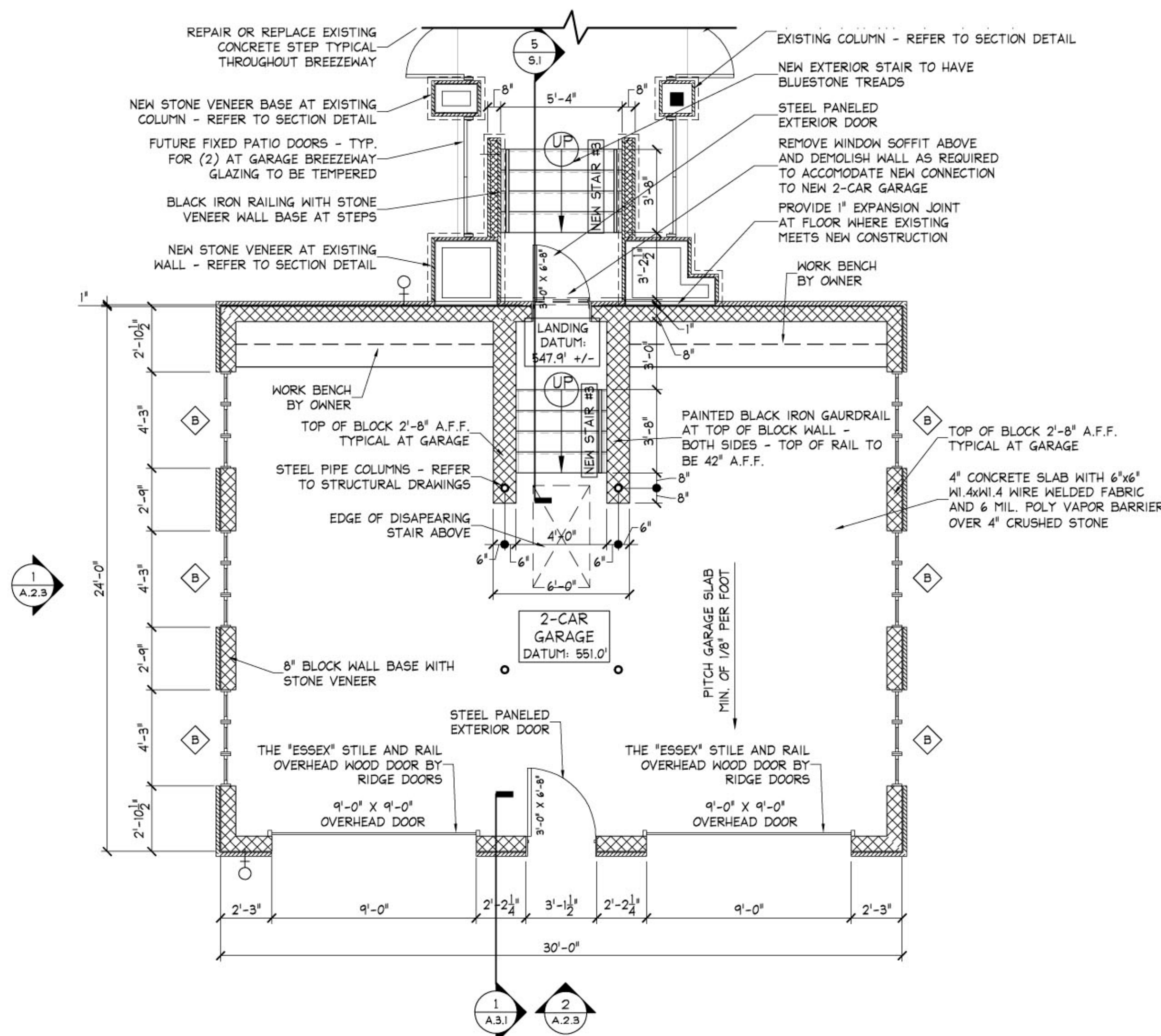
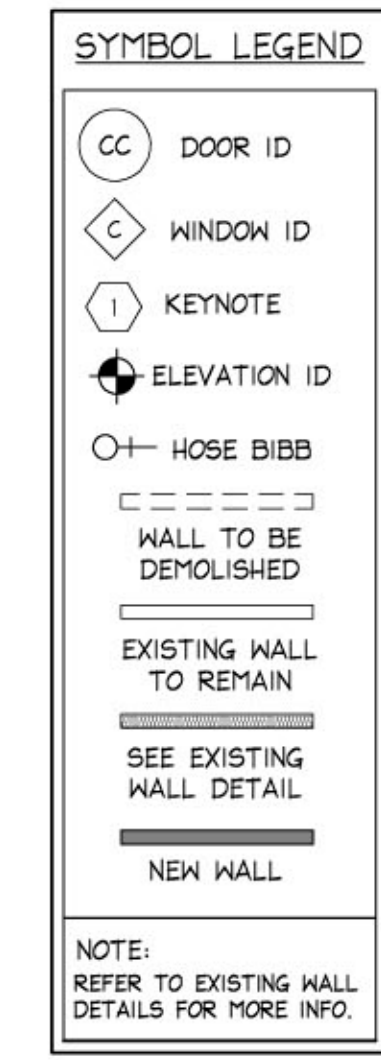
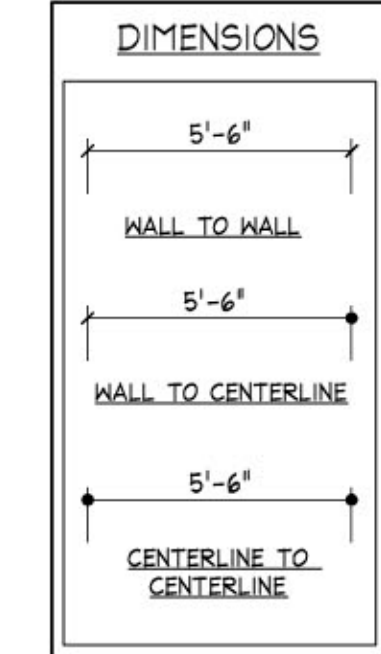

2 GARAGE FLOOR PLAN
A.1.2 SCALE: 1/4" = 1'-0"

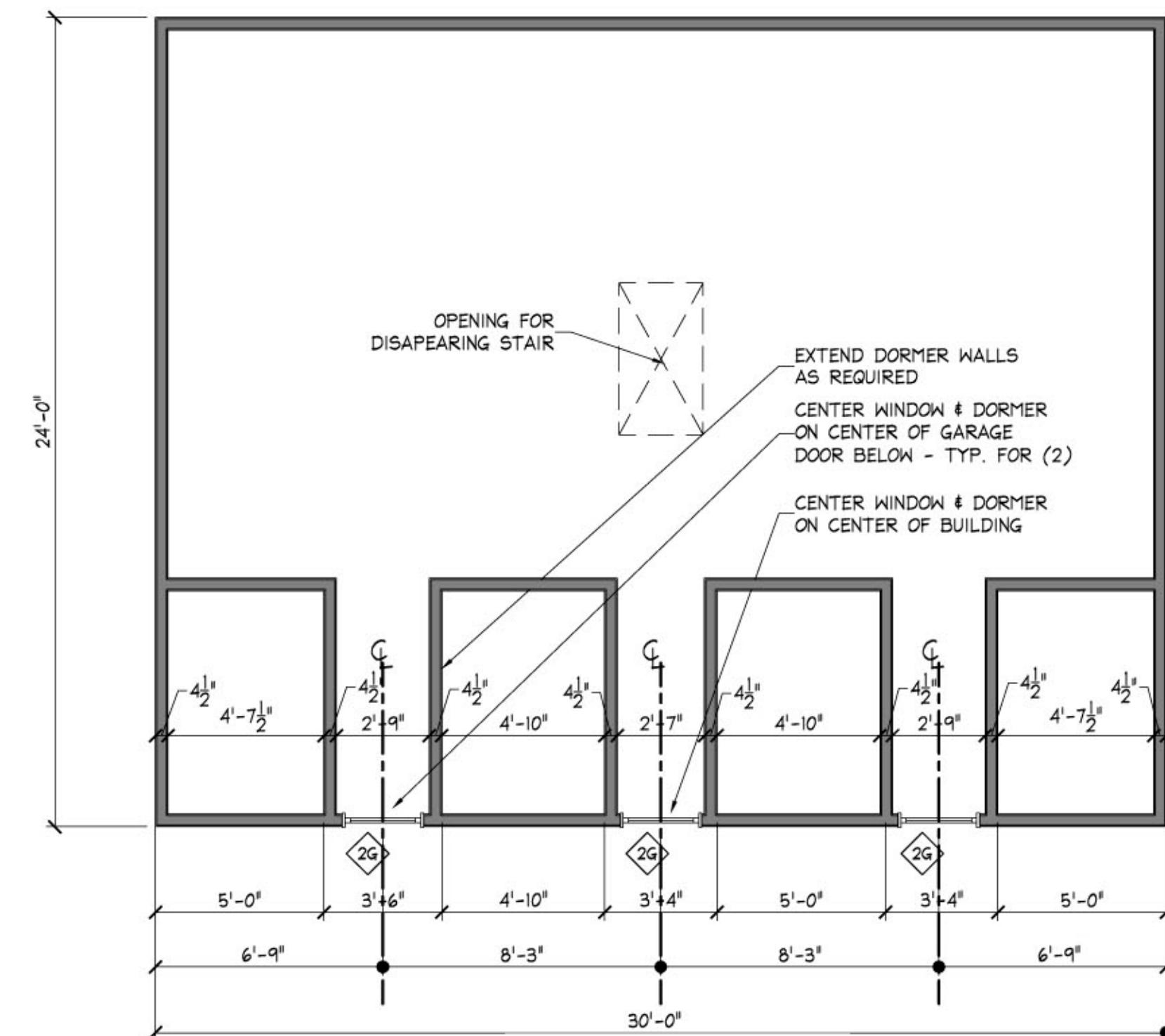

3 GARAGE ATTIC PLAN
A.1.2 SCALE: 1/4" = 1'-0"

PERMIT SET

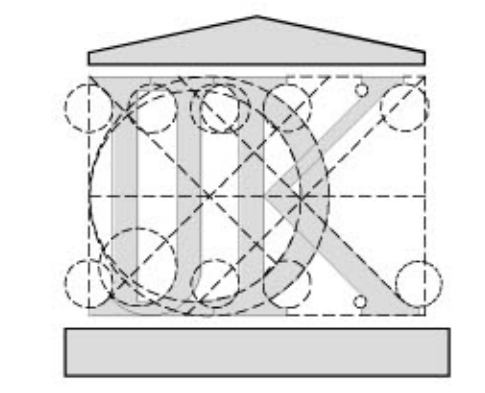

Dennis Kowal Architects
52 West Main Street
Somerville, New Jersey 08876
908-231-0201 FAX 908-218-7979
Lot #6
Block #1801
88 West Main Street
Mendham, New Jersey
Morris County

St. Hilda's Lodge Renovation

AS SHOWN JOB NUMBER 0414
DATE 13 SEPT 2004 DRAWN BY SMM

BASEMENT & GARAGE FLOOR PLANS

SHEET NUMBER
A.1.2